

## ▶ Mechatronic systems

8860



ACCURACY



SMART



HIGH PROTECTION DEGREES

- Size NEMA 23 ..... 1.5", 2", 3"
- Torque..... up to 1.9 Nm



The smart actuator is a complete drive system with self-adaptive driver, able to detect torque/position. Available with several communication options.

### ▶ Technical data

Part N°	Power supply (+/- 20%) [VDC]	Rotor inertia [gcm <sup>2</sup> ]	Holding torque [mNm]	Weight [g]
8860-15	12/24	131	540	~ 400
8860-20	12/24	248	925	~ 600
8860-30	12/24	425	1950	~ 1000

Communication interface: Frequency / Direction. Optional: RS232/RS485, CAN, I<sup>2</sup>C, other. 48V, 60V and other Voltage on request.

### ▶ Main Features

- Closed loop control
- Maximum efficiency / optimal power consumption
- Low noise and low vibrations design
- Low heat generation
- High torque at low speed

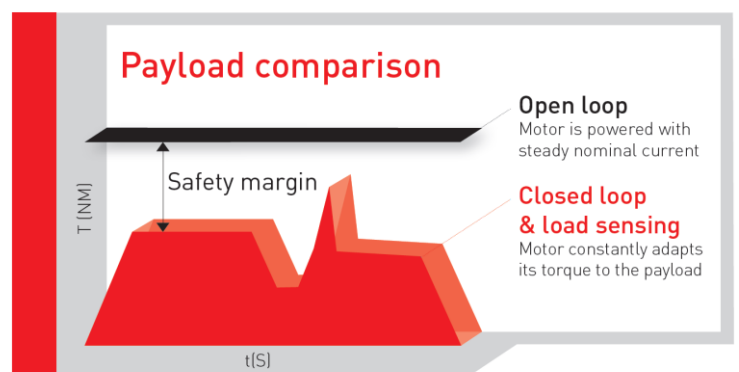

The intelligent electronics permanently adapts the phase current to meet the torque load

► Dimensions

Drawing not to scale. All dimensions in mm.

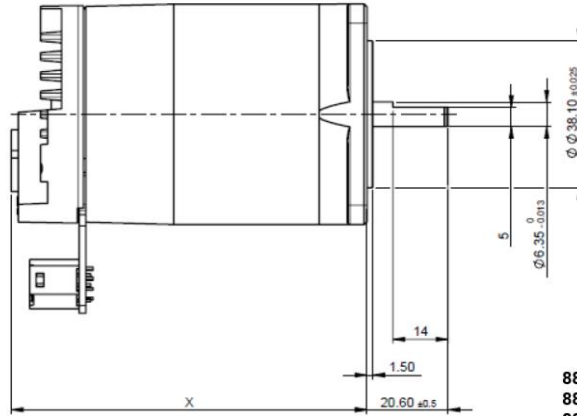
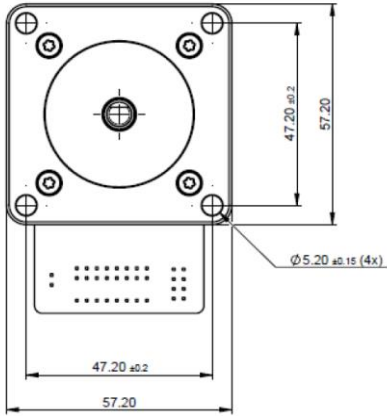

8860-15 : X = 66mm  
 8860-20 : X = 78mm  
 8860-30 : X = 103mm

► Thermal and torque characteristics

• 8860-15-2-1.6

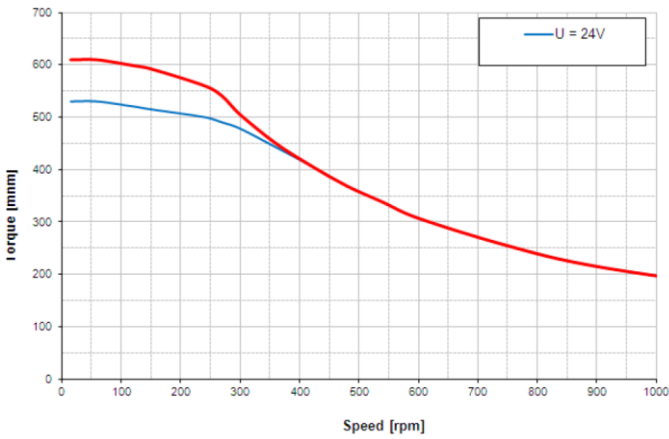

• 8860-20-2-0.37

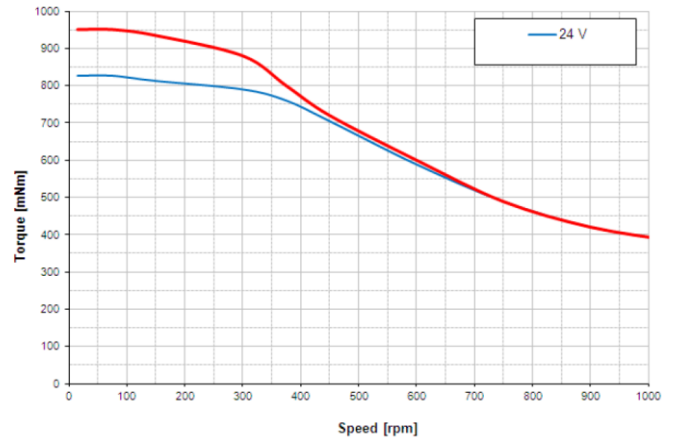

• 8860-30-2-0.37

